



PLUS & STAINLESS

CASEWORK CATALOG



**THE SCIENCE OF INNOVATION
THE ART OF DISCOVERY**

TABLE OF CONTENTS

Cabinet Configurator.....	02
Features & Specifications.....	03
Base Cabinet- Sinks.....	04
Base Cabinets- Doors Only.....	05
Base Cabinets- Drawers & Doors.....	05
Base Cabinets- 3 Drawers & Door.....	06
Base Cabinets- 4 Drawers & Door.....	06
Base Cabinets- 5 Drawers & Door.....	06
Base Cabinets- 5 Drawers & Door.....	06
Base Cabinets- Drawers Only.....	06
Wall Cabinets.....	07
Tall Storage.....	08
Workstation Features.....	09
Workstations.....	10
Workstation Shelves.....	10
Universal Storage.....	11
Height Adjustable Sink.....	12
Height Adjustable Workstation.....	12

PLUS & STAINLESS CABINET CONFIGURATOR

Torvan UNILAB Cabinet Configurator is designed to help you select your cabinetry as per your preferences for cabinet type, style, front material, dimensions (D x H x W), door quantity, drawer quantity, and cabinet modifiers.

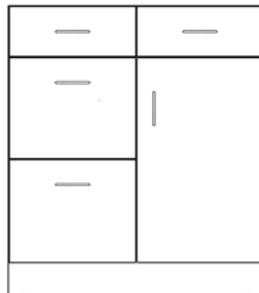
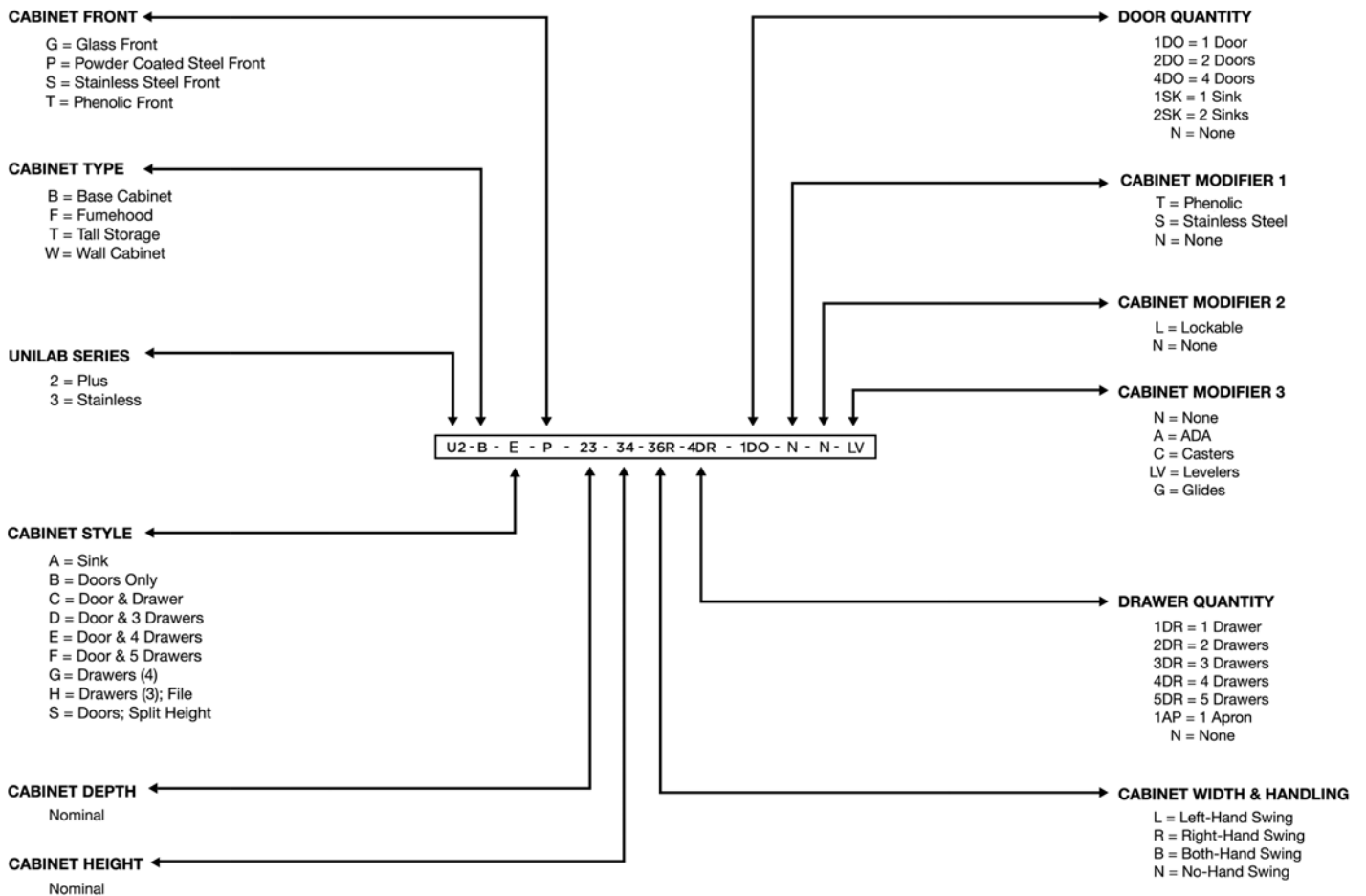

U2-B-E-P-23-34-36R-4DR-1DO-N-N-LV

FEATURES

Flexible and adaptable: mobile, modular components for ease of set-up, reconfigurations, or relocation

Standard phenolic work surfaces: durable, chemical resistant, high grade surface suitable for all types of labs

Cabinet Front Material: choice of powder coated (standard), stainless steel, phenolic surfaces, with various color options

Durable: stand up to the most demanding environments and, improve organization and accessibility, while saving space

Easy Installation: shipped assembled for quick lab set up

Warranty: Torvan UNILAB products guaranteed against defects in materials and workmanship for a period of ONE year

SPECIFICATIONS

Painted Cabinetry: Standard white, lab grade powdered coat, custom colors and materials priced upon request

Stainless Cabinetry: Standard 304 #4 Brushed Finish, other materials (such as 316) and finishes priced upon request

Standard Work Surfaces: Black Phenolic. Other colors and materials (powder coated, stainless steel, epoxy) priced on request.

BASE CABINETS-SINK

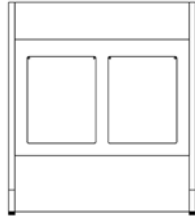
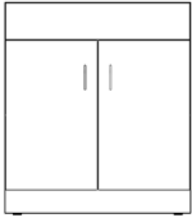

Complete width Apron Sink
base cabinet units in 3 sizes
- 30" wide, 36" wide, 48"
wide

23"(d) x 34"(h) x 30" (w)
23"(d) x 34"(h) x 36" (w)
23"(d) x 34"(h) x 48" (w)

U2-B-A-P-23-34-30B-1AP-2DO-N-N-LV
U3 S 36B S L
T 48B

U2-B-A-P-23-33-30N-1AP-N-N-N-A
U3 S 38N G
T 48N



1 door units, left or right-hand
swing

23"(d) x 34"(h) x 18" (w)
23"(d) x 34"(h) x 24" (w)

U2-B-A-P-23-34-18(L/R)-1AP-1DO-N-N-LV
U3 S 24(L/R) S L
T

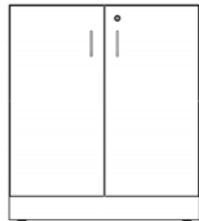
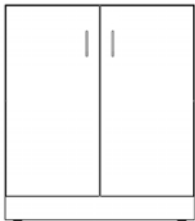

Base cabinet sink unit without
apron in 3 sizes - 30" wide,
36" wide, 48" wide
-lock options

23"(d) x 34"(h) x 30" (w)
23"(d) x 34"(h) x 36" (w)
23"(d) x 34"(h) x 48" (w)

U2-B-A-P-23-34-30B-N-2DO-N-N-LV
U3 S 36B S
T 48B

U2-B-A-P-23-34-30B-N-2DO-N-L-LV
U3 S 36B S
T 48B

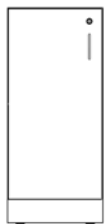

1 door units, left or right-hand
swing

23"(d) x 34"(h) x 18" (w)
23"(d) x 34"(h) x 24" (w)

U2-B-A-P-23-34-18(L/R)-N-1DO-N-L-LV
U3 S 24(L/R) S
T

Description

D x H x W

BASE CABINETS- DOORS ONLY

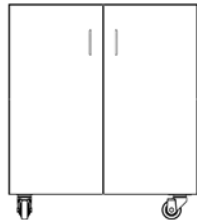
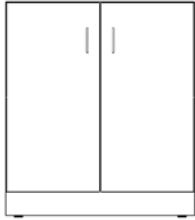

Base cabinet with 2 doors
-levelers or casters
-lock options

23"(d) x 34"(h) x 30" (w)
23"(d) x 34"(h) x 36" (w)
23"(d) x 34"(h) x 48" (w)

23"(d) x 28"(h) x 30" (w)
23"(d) x 28"(h) x 36" (w)
23"(d) x 28"(h) x 48" (w)

U2-B-B-P-23-34-30B-N-2D0-N-N-LV
U3 S 28 36B S
T 48B

U2-B-B-P-23-34-30B-N-2D0-N-N-C
U3 S 28 36B S
T 48B

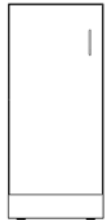

Base cabinet with 1 door
-levelers or casters
-lock options

23"(d) x 34"(h) x 15" (w)
23"(d) x 34"(h) x 16" (w)
23"(d) x 34"(h) x 24" (w)

23"(d) x 28"(h) x 15" (w)
23"(d) x 28"(h) x 16" (w)
23"(d) x 28"(h) x 24" (w)

U2-B-B-P-23-34-15(L/R)-N-1D0-N-N-LV
U3 S 28 18(L/R) S L
T 24(L/R)

U2-B-B-P-23-34-15(L/R)-N-1D0-N-N-C
U3 S 28 18(L/R) S L
T 24(L/R)

BASE CABINETS- DRAWERS & DOORS

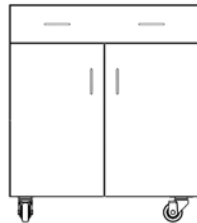
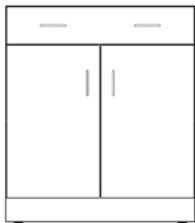

Base cabinet- 1 & 2 Drawers,
1 & 2 Doors- w/casters - both
standing and sitting heights

23"(d) x 34"(h) x 30" (w)
23"(d) x 34"(h) x 36" (w)
23"(d) x 34"(h) x 48" (w)

23"(d) x 28"(h) x 30" (w)
23"(d) x 28"(h) x 36" (w)
23"(d) x 28"(h) x 48" (w)

U2-B-C-P-23-34-30B-1DR-2D0-N-N-LV
U3 S 28 36B S L
T 48B

U2-B-C-P-23-34-30B-1DR-2D0-N-N-C
U3 S 28 36B S L
T 48B

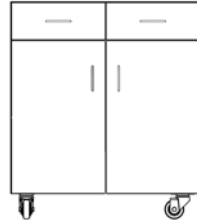
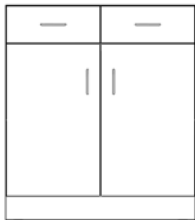

2 Drawer, 2 Door cabinet- w/
casters,

23"(d) x 34"(h) x 30" (w)
23"(d) x 34"(h) x 36" (w)
23"(d) x 34"(h) x 48" (w)

23"(d) x 28"(h) x 30" (w)
23"(d) x 28"(h) x 36" (w)
23"(d) x 28"(h) x 48" (w)

U2-B-C-P-23-34-30B-2DR-2D0-N-N-LV
U3 S 28 36B S L
T 48B

U2-B-C-P-23-34-30B-2DR-2D0-N-N-C
U3 S 28 36B S L
T 48B

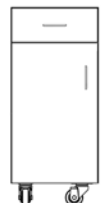

1 Drawer, 1 Door cabinet- w/
casters

23"(d) x 34"(h) x 15" (w)
23"(d) x 34"(h) x 16" (w)
23"(d) x 34"(h) x 24" (w)

23"(d) x 28"(h) x 15" (w)
23"(d) x 28"(h) x 16" (w)
23"(d) x 28"(h) x 24" (w)

U2-B-C-P-23-34-15(L/R)-1DR-1D0-N-N-LV
U3 S 28 18(L/R) S L
T 24(L/R)

U2-B-C-P-23-34-15(L/R)-1DR-1D0-N-N-C
U3 S 28 18(L/R) S L
T 24(L/R)

Description

D x H x W

BASE CABINETS- 3 DRAWERS & DOOR

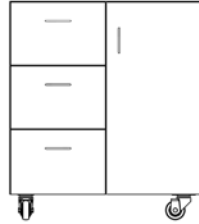
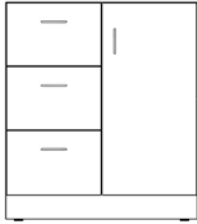

U2-B-D-P-23-34-30(L/R)-3DR-1DO-N-N-LV
U3 S 28 36(L/R) S L
T 48(L/R)

U2-B-D-P-23-34-30(L/R)-3DR-1DO-N-N-C
U3 S 28 36(L/R) S L
T 48(L/R)

Base Cabinets with 3 drawers,
1 door
-leveler or caster
-lock options
-left or right-hand swing

23"(d) x 34"(h) x 30" (w)
23"(d) x 34"(h) x 36" (w)
23"(d) x 34"(h) x 48" (w)

23"(d) x 28"(h) x 30" (w)
23"(d) x 28"(h) x 36" (w)
23"(d) x 28"(h) x 48" (w)

BASE CABINETS- 4 DRAWERS & DOOR

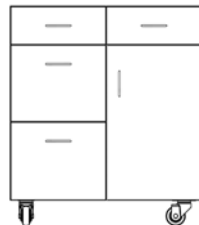
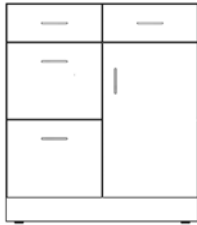

U2-B-E-P-23-34-30(L/R)-4DR-1DO-N-N-LV
U3 S 28 36(L/R) S L
T 48(L/R)

U2-B-E-P-23-34-30(L/R)-4DR-1DO-N-N-C
U3 S 28 36(L/R) S L
T 48(L/R)

Base Cabinets with 4 drawers,
1 door
-leveler or caster
-lock options
-left right-hand swing

23"(d) x 34"(h) x 30" (w)
23"(d) x 34"(h) x 36" (w)
23"(d) x 34"(h) x 48" (w)

23"(d) x 28"(h) x 30" (w)
23"(d) x 28"(h) x 36" (w)
23"(d) x 28"(h) x 48" (w)

BASE CABINETS- 5 DRAWERS & DOOR

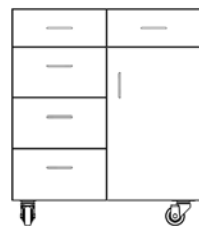
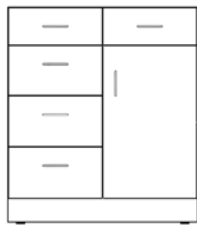

U2-B-F-P-23-34-30(L/R)-5DR-1DO-N-N-LV
U3 S 28 36(L/R) S L
T 48(L/R)

U2-B-F-P-23-34-30(L/R)-5DR-1DO-N-N-C
U3 S 28 36(L/R) S L
T 48(L/R)

Base Cabinets with 5 drawers,
1 door
-leveler or caster
-lock options
-left or right-hand swing

23"(d) x 34"(h) x 30" (w)
23"(d) x 34"(h) x 36" (w)
23"(d) x 34"(h) x 48" (w)

23"(d) x 28"(h) x 30" (w)
23"(d) x 28"(h) x 36" (w)
23"(d) x 28"(h) x 48" (w)

BASE CABINETS- DRAWERS ONLY



U2-B-G-P-23-34-30N-4DR-N-N-N-LV
U3 S 28 36N S L C
T 48N

U2-B-G-P-23-34-18N-4DR-N-N-N-LV
U3 S 28 24N S L C
T

Base Cabinets with 4 drawers
-leveler or casters
-lock options

23"(d) x 34"(h) x 18" (w)
23"(d) x 34"(h) x 24" (w)
23"(d) x 34"(h) x 30" (w)



U2-B-H-P-23-28-15N-3DR-N-N-N-LV
U3 S 18N S L
T

U2-B-H-P-23-28-15N-3DR-N-N-N-C
U3 S 18N S L
T

Base Cabinets with 3 drawers
-leveler or casters
-lock options

23"(d) x 28"(h) x 15" (w)
23"(d) x 28"(h) x 18" (w)

WALL CABINETS

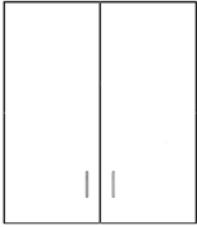

Wall Cabinet 2 door & 1 door
 -2 shelves,
 -1 door cabinets with left or
 right-hand swing
 -lock options

11"(d) x 36"(h) x 30" (w)
 11"(d) x 36"(h) x 36" (w)
 11"(d) x 36"(h) x 48" (w)
 11"(d) x 36"(h) x 15" (w)
 11"(d) x 36"(h) x 18" (w)
 11"(d) x 36"(h) x 24" (w)

U2-W-B-P-11-36-30B-N-2D0-N-N-LV
 U3 S 36B S L
 T 48B

U2-W-B-P-11-36-15(L/R)-N-1D0-N-N-LV
 U3 S 18(L/R) S L
 T 24(L/R)

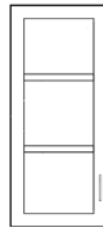
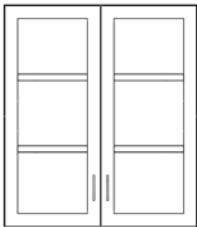

Wall Cabinet- Glass Panel,
 2 door & 1 door
 -2 shelves,
 -1 door cabinets with left or
 right-hand swing
 -lock options

11"(d) x 36"(h) x 30" (w)
 11"(d) x 36"(h) x 36" (w)
 11"(d) x 36"(h) x 48" (w)
 11"(d) x 36"(h) x 15" (w)
 11"(d) x 36"(h) x 18" (w)
 11"(d) x 36"(h) x 24" (w)

U2-W-B-G-11-36-30B-N-2D0-N-N-LV
 U3 S 36B S L
 T 48B

U2-W-B-G-11-36-15(L/R)-N-1D0-N-N-LV
 U3 S 18(L/R) S L
 T 24(L/R)

Description

D x H x W

TALL STORAGE

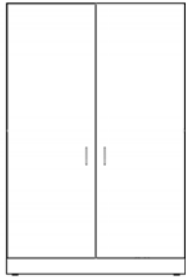

Tall Storage. 2 door & 1 door
-5 shelves,
-1 door storage cabinets with
left or right-hand swing
-lock options

17"(d) x 90"(h) x 30" (w)
17"(d) x 90"(h) x 36" (w)
17"(d) x 90"(h) x 48" (w)
23"(d) x 90"(h) x 30" (w)
23"(d) x 90"(h) x 36" (w)
23"(d) x 90"(h) x 48" (w)

17"(d) x 90"(h) x 15" (w)
17"(d) x 90"(h) x 18" (w)
17"(d) x 90"(h) x 24" (w)
23"(d) x 90"(h) x 15" (w)
23"(d) x 90"(h) x 18" (w)
23"(d) x 90"(h) x 24" (w)

U2-T-B-P-17-90-30B-N-200-N-N-LV
U3 S 23 36B S L
T 48B

U2-T-B-P-17-90-15(L/R)-N-100-N-N-LV
U3 S 23 18(L/R) S L
T 24(L/R)

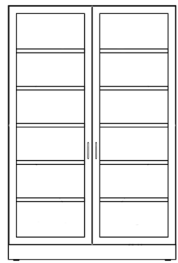

Tall Storage- Glass Panels,
2 door & 1 door
-5 shelves
-1 door storage cabinets with
left or right-hand swing
-lock options

17"(d) x 90"(h) x 30" (w)
17"(d) x 90"(h) x 36" (w)
17"(d) x 90"(h) x 48" (w)
23"(d) x 90"(h) x 30" (w)
23"(d) x 90"(h) x 36" (w)
23"(d) x 90"(h) x 48" (w)

17"(d) x 90"(h) x 15" (w)
17"(d) x 90"(h) x 18" (w)
17"(d) x 90"(h) x 24" (w)
23"(d) x 90"(h) x 15" (w)
23"(d) x 90"(h) x 18" (w)
23"(d) x 90"(h) x 24" (w)

U2-T-B-G-17-90-30B-N-200-N-N-LV
U3 23 36B S L
48B

U2-T-B-G-17-90-15(L/R)-N-100-N-N-LV
U3 23 18(L/R) S L
24(L/R)

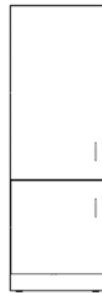
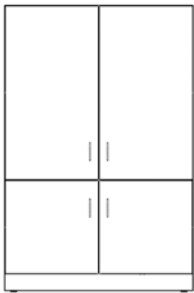

Tall Storage- Split Doors,
4 door & 2 door
-3 shelves top storage, 1 shelf
bottom storage
-1 door storage cabinets with
left or right-hand swing
-lock options

17"(d) x 90"(h) x 30" (w)
17"(d) x 90"(h) x 36" (w)
17"(d) x 90"(h) x 48" (w)
23"(d) x 90"(h) x 30" (w)
23"(d) x 90"(h) x 36" (w)
23"(d) x 90"(h) x 48" (w)

17"(d) x 90"(h) x 15" (w)
17"(d) x 90"(h) x 18" (w)
17"(d) x 90"(h) x 24" (w)
23"(d) x 90"(h) x 15" (w)
23"(d) x 90"(h) x 18" (w)
23"(d) x 90"(h) x 24" (w)

U2-T-S-P-17-90-30B-N-400-N-N-LV
U3 S 23 36B S L
T 48B

U2-T-S-P-17-90-15(L/R)-N-200-N-N-LV
U3 S 23 18(L/R) S L
T 24(L/R)

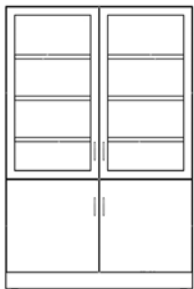

Tall Storage- Split & Split Combo, 4
Door & 2 Door w/Glass Panels
-3 shelves top storage, 1 shelf
bottom storage
-1 door storage cabinets with
left or right-hand swing
-lock options

17"(d) x 90"(h) x 30" (w)
17"(d) x 90"(h) x 36" (w)
17"(d) x 90"(h) x 48" (w)
23"(d) x 90"(h) x 30" (w)
23"(d) x 90"(h) x 36" (w)
23"(d) x 90"(h) x 48" (w)

17"(d) x 90"(h) x 15" (w)
17"(d) x 90"(h) x 18" (w)
17"(d) x 90"(h) x 24" (w)
23"(d) x 90"(h) x 15" (w)
23"(d) x 90"(h) x 18" (w)
23"(d) x 90"(h) x 24" (w)

U2-T-S-G-17-90-30B-N-400-N-N-LV
U3 23 36B S L
48B

U2-T-S-G-17-90-15(L/R)-N-200-N-N-LV
U3 23 18(L/R) S L
24(L/R)

FEATURES

Height Adjustability: made easy without the use of tools

Complete Assemblies: allowing them to be stand-alone benches or built-in

Quick Release Fasteners: benches can be disconnected from the core for easy relocation and repurposing

Tapered Profiles: allows sight lines to be maintained

Concealed Services: an efficient design that allows equipment to be positioned more easily - providing a clean, uncluttered work space

Available Custom End Panels: variety of different patterns and materials for a custom, modern look

Warranty: Torvan UNILAB products guaranteed against defects in materials and workmanship for a period of ONE year

Product Number	Description	D x H x W
----------------	-------------	-----------

BENCHES



U2-TBL-P-30HA36-T
 U2-TBL-P-30HA48-T
 U2-TBL-P-30HA60-T
 U2-TBL-P-30HA72-T
 U3-TBL-P-30HA36-T
 U3-TBL-P-30HA48-T
 U3-TBL-P-30HA60-T
 U3-TBL-P-30HA72-T

Stand alone height adjustable bench
 -phenolic top

30"(d) x ADJ(h) x 36" (w)
 30"(d) x ADJ(h) x 48" (w)
 30"(d) x ADJ(h) x 60" (w)
 30"(d) x ADJ(h) x 72" (w)



U2-TBL-P-32HA36-T
 U2-TBL-P-32HA48-T
 U2-TBL-P-32HA60-T
 U2-TBL-P-32HA72-T
 U2-TBL-P-32HA36-T
 U2-TBL-P-32HA48-T
 U2-TBL-P-32HA60-T
 U2-TBL-P-32HA72-T

Single height adjustable bench with service module
 -phenolic top
 -quick release fasteners

36"(d) x ADJ(h) x 36" (w)
 36"(d) x ADJ(h) x 48" (w)
 36"(d) x ADJ(h) x 60" (w)
 36"(d) x ADJ(h) x 72" (w)



U2-TBL-P-60HA36-T
 U2-TBL-P-60HA48-T
 U2-TBL-P-60HA60-T
 U2-TBL-P-60HA72-T

Double sided height adjustable bench with service module
 -phenolic top
 -quick release fasteners

60"(d) x ADJ(h) x 36" (w)
 60"(d) x ADJ(h) x 48" (w)
 60"(d) x ADJ(h) x 60" (w)
 60"(d) x ADJ(h) x 72" (w)

BENCH SHELVES



U2-TBL-SHELF-SNG-1-36
 U2-TBL-SHELF-SNG-1-48
 U2-TBL-SHELF-SNG-1-60
 U2-TBL-SHELF-SNG-1-72

Single sided shelf no retainer rod

36" (w)
 48" (w)
 60" (w)
 72" (w)



U2-TBL-SHELF-SNG-2-36
 U2-TBL-SHELF-SNG-2-48
 U2-TBL-SHELF-SNG-2-60
 U2-TBL-SHELF-SNG-2-72

Single sided shelf with retainer rod

36" (w)
 48" (w)
 60" (w)
 72" (w)



U2-TBL-SHELF-DBL-1-36
 U2-TBL-SHELF-DBL-1-48
 U2-TBL-SHELF-DBL-1-60
 U2-TBL-SHELF-DBL-1-72

Double sided shelf no retainer rod

36" (w)
 48" (w)
 60" (w)
 72" (w)



U2-TBL-SHELF-DBL-2-36
 U2-TBL-SHELF-DBL-2-48
 U2-TBL-SHELF-DBL-2-60
 U2-TBL-SHELF-DBL-2-72

Double sided shelf with retainer rod

36" (w)
 48" (w)
 60" (w)
 72" (w)

Product Number

Configuration

D x H x W

UNIVERSAL STERILE PRODUCT STORAGE CABINET

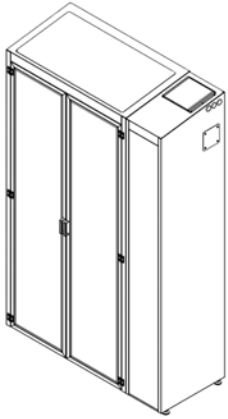

T7-362492-SS

- Positive Pressure HEPA Ventilation
- Brushed Stainless
- Tempered Glass Doors
- *Storage configurations, environmental monitoring, and security options available

24"(d) x 94"(h) x 49"(w)

UNIVERSAL STORAGE CABINET

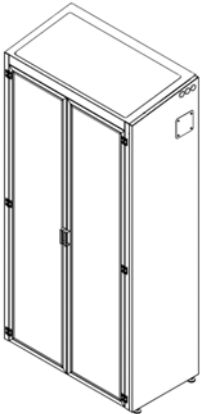

T7-362492

- Brushed Stainless
- Tempered Glass Doors
- *Storage configurations, environmental monitoring, and security options available

24"(d) x 94"(h) x 36"(w)

*Please talk to a representative for specific information and configurations.

Product Number	Configuration	D x H x W
----------------	---------------	-----------

HEIGHT ADJUSTABLE SINK

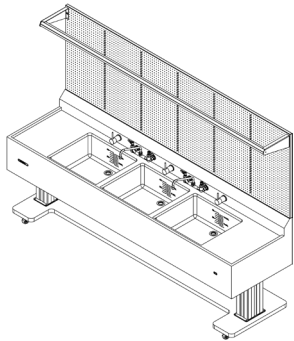

T2-1B-6030HA	-Coved Sink Basins w. Gallon Etching -24" High Modular Pegboard Accessory Area	SINGLE BASIN 30"(d) x ADJ(h) x 50-71"(w)
T2-2B-6030HA T2-2B-8430HA T2-2B-9630HA	-LED Overhead Tilt Light -Ergonomic Externally Operated Pull Drains -Backsplash Mount 8" Swing Spout Faucets	DOUBLE BASIN 30"(d) x ADJ(h) x 72-83"(w) 30"(d) x ADJ(h) x 84-95"(w) 30"(d) x ADJ(h) x 96-107"(w)
T2-3B-9630HA T2-2B-12030HA	-Outlets & Electrical Under Sink Skirt -Lock & Leveling Swivel Casters -Marine & Wrist Friendly Edges	TRIPLE BASIN 30"(d) x ADJ(h) x 96-107"(w) 30"(d) x ADJ(h) x 108-120"(w)

HEIGHT ADJUSTABLE WORKSTATIONS

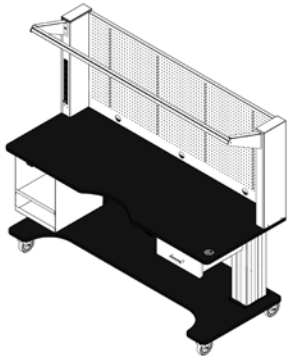

T5-PP-7630TPHA-SB T5-PP-6430TPHA-SB T5-PP-4830TPHA-SB	-Phenolic/stainless steel top -Height Adjusting Columns	30"(d) x ADJ(h) x 48"(w) 30"(d) x ADJ(h) x 64"(w) 30"(d) x ADJ(h) x 76"(w)
T5-PP-7636TPHA-SB T5-PP-6436TPHA-SB T5-PP-4836TPHA-SB	-Locking Swivel Casters -LED Overhead Tilt Light -Powered Utility Frame with Inset Electrical Strip	36"(d) x ADJ(h) x 48"(w) 36"(d) x ADJ(h) x 64"(w) 36"(d) x ADJ(h) x 76"(w)
T5-PP-7630SSHA-SB T5-PP-6430SSHA-SB T5-PP-4830SSHA-SB	-Stainless Steel Drawer -Stainless Steel Pegboard	
T5-PP-7636SSHA-SB T5-PP-6436SSHA-SB T5-PP-4836SSHA-SB		

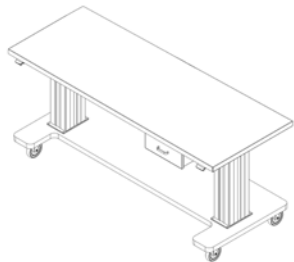

T5-BT-7630SSHA-SB T5-BT-6430SSHA-SB T5-BT-4830SSHA-SB	-Stainless Steel Tabletop, Square Edged -Height Adjusting Columns	30"(d) x ADJ(h) x 48"(w) 30"(d) x ADJ(h) x 64"(w) 30"(d) x ADJ(h) x 76"(w)
T5-BT-7636SSHA-SB T5-BT-6436SSHA-SB T5-BT-4836SSHA-SB	-Locking Swivel Casters -Powered Utility Frame with Inset Electrical Strip -Stainless Steel Drawer	36"(d) x ADJ(h) x 48"(w) 36"(d) x ADJ(h) x 64"(w) 36"(d) x ADJ(h) x 76"(w)

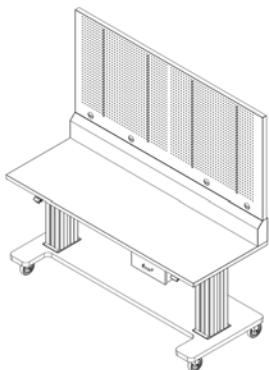

T5-EA-7630SSHA-SB T5-EA-6430SSHA-SB T5-EA-4830SSHA-SB	-Stainless Steel Tabletop, Square Edged -Solid Stainless Steel Base with Ankle Cutout Space	30"(d) x ADJ(h) x 48"(w) 30"(d) x ADJ(h) x 64"(w) 30"(d) x ADJ(h) x 76"(w)
T5-EA-7636SSHA-SB T5-EA-6436SSHA-SB T5-EA-4836SSHA-SB	-Locking Swivel Casters -Height Adjusting Columns -Angled Stainless Steel Backsplash -Undermounted Power Bar -Stainless Steel Drawer -Stainless Steel Pegboard	36"(d) x ADJ(h) x 48"(w) 36"(d) x ADJ(h) x 64"(w) 36"(d) x ADJ(h) x 76"(w)

PLANNING TOOLS

Torvan Medical is always evolving to make lab planning and workflow analysis easier for our customers.

Please visit our website for our updated line of planning tools and models such as online configurators.

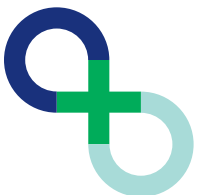

Torvan UNILAB
A division of
Torvan Medical INC

1-888-832-0355

www.torvanmedical.com



FM 692762