



CLASSIC

PRODUCT CATALOG



**THE SCIENCE OF INNOVATION
THE ART OF DISCOVERY**

TABLE OF CONTENTS

Cabinet Configurator.....	02
Features & Specifications.....	03
Double Sink Cabinets.....	04
Single Sink Cabinets.....	04
Standing Height Cabinets.....	05
Sitting Height Cabinets.....	06
Shelf Cubicles.....	07
Shelf Cubicle Assembly.....	08
Upper Cabinets.....	09
Upper Cabinet Assembly.....	10
Sitting Height Benches.....	11
Standing Height Benches.....	12

UNILAB CLASSIC CABINET CONFIGURATOR

Torvan UNILAB Cabinet Configurator is designed to help you select your cabinetry as per your preferences for cabinet type, style, front material, dimensions (D x H x W), door quantity, drawer quantity, and cabinet modifiers.

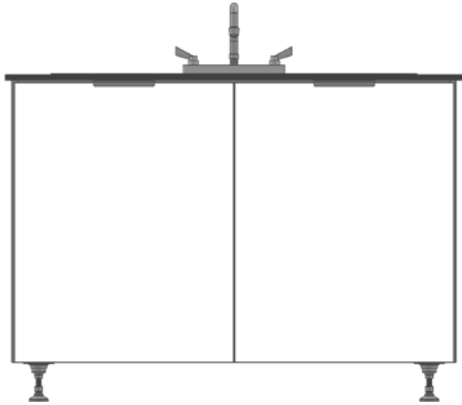
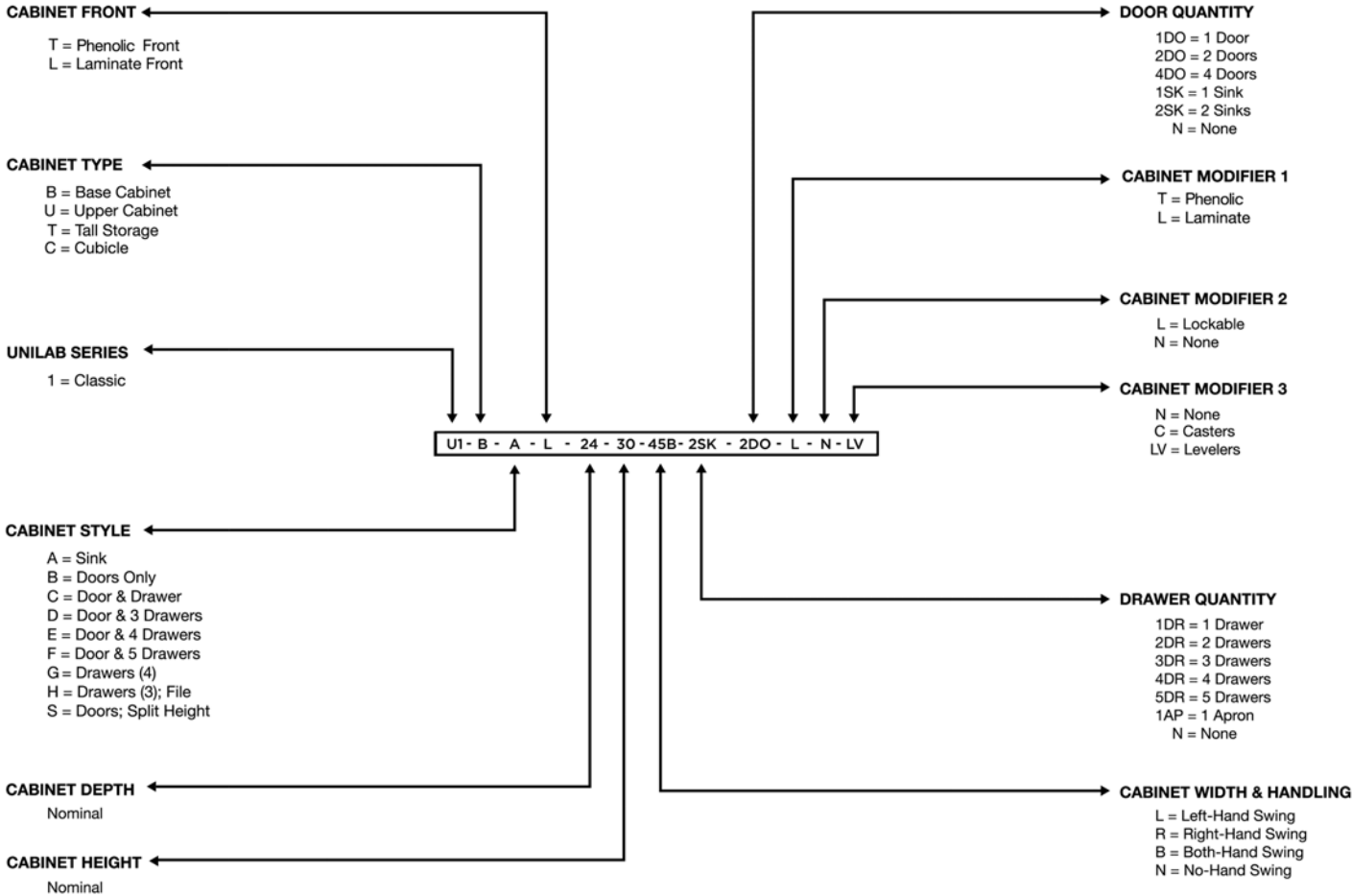

U1-B-A-L-24-30-45B-2SK-2DO-L-N-LV

FEATURES

Flexible and adaptable: easy installation, mobile, modular components for ease of set-up, reconfigurations or relocation

Cost effective: designed for easy reconfiguration, perfect for small renovations, and start up labs

Soft close drawers: one touch – easy to close – glides back into place

Stainless steel legs and handles: easy to clean, safe for any type of lab

Standard phenolic work surfaces: durable, chemical resistant, high grade surface suitable for all types of labs

Warranty: Torvan UNILAB products guaranteed against defects in materials and workmanship for a period of ONE year

SPECIFICATIONS

Table Height: Standard 30” or 36”

Choice of Colors: White, grey are standard. Custom colors are available, priced upon request

Stainless Legs: Standard 304 #4 Brushed Finish, other materials (such as 316) and finishes priced upon request

Standard Work Surfaces: Black phenolic. Other colors and materials (powder coated, stainless steel, epoxy) priced on request.

Product Number	Description	D x H x W
----------------	-------------	-----------

DOUBLE SINK CABINETS

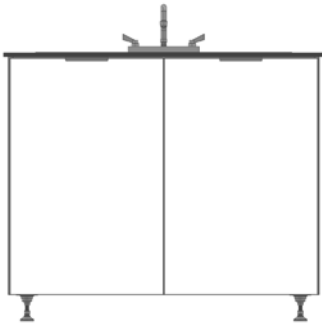

U1-B-A-L-24-36-45B-2SK-2D0-L-N-LV

Double Sink Cabinet
Phenolic Top 24 x 36 x 45" - sink
basins, faucet, and plumbing not
included

24"(d) x 36"(h) x 45"(w)

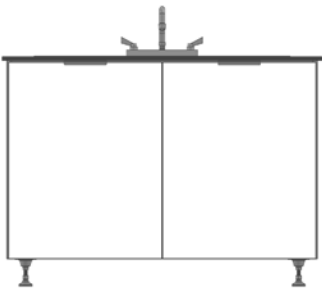

U1-B-A-L-24-30-45B-2SK-2D0-L-N-LV

Double Sink Cabinet
Phenolic Top 24 x 30 x 45" - sink
basins, faucet, and plumbing not
included

24"(d) x 30"(h) x 45"(w)

SINGLE SINK CABINETS

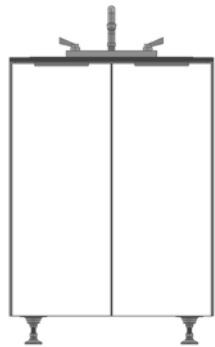

U1-B-A-L-24-36-23B-1SK-2D0-L-N-LV

Single Sink Cabinet
Phenolic Top 24 x 36 x 22.5" -
sink basin, faucet, and plumbing
not included

24"(d) x 36"(h) x 22.5"(w)

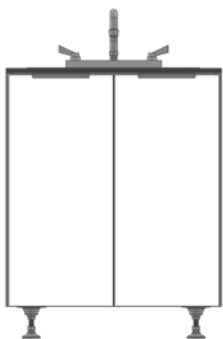

U1-B-A-L-24-30-23B-1SK-2D0-L-N-LV

Single Sink Cabinet
Phenolic Top 24 x 30 x 22.5" -
sink basin, faucet, and plumbing
not included

24"(d) x 30"(h) x 22.5"(w)

Product Number	Description	D x H x W
----------------	-------------	-----------

STANDING HEIGHT CABINETS

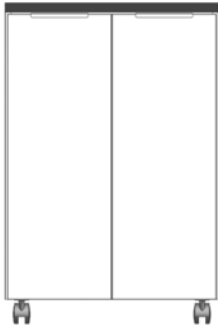

0.64 in

U1-B-B-L-23-34-23B-N-2D0-L-N-C

Mobile Standing Base Cabinet (36")
with phenolic work surface
-2 doors, 1 shelf

22.5"(d) x 34"(h) x 22.5"(w)

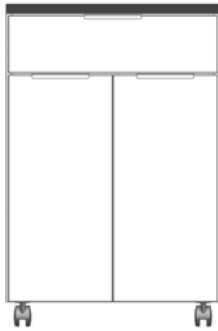

U1-B-C-L-23-34-23B-1DR-2D0-L-N-C

Mobile Standing Base Cabinet (36")
with phenolic work surface
-1 soft close drawer, 2 doors, 1
shelf

22.5"(d) x 34"(h) x 22.5"(w)

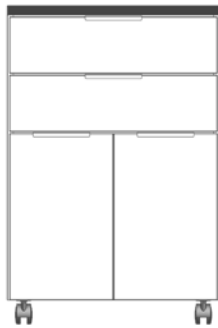

U1-B-C-L-23-34-23B-2DR-2D0-L-N-C

Mobile Standing Base Cabinet (36")
with phenolic work surface
-2 soft close drawers, 2 doors

22.5"(d) x 34"(h) x 22.5"(w)



U1-B-G-L-23-34-23N-4DR-N-L-N-C

Mobile Standing Base Cabinet (36")
with phenolic work surface
-4 soft close drawers

22.5"(d) x 34"(h) x 22.5"(w)

Product Number	Description	D x H x W
----------------	-------------	-----------

SITTING HEIGHT CABINETS

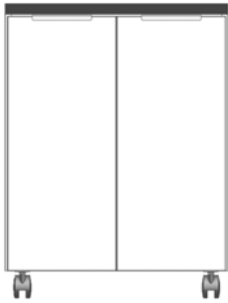

U1-B-B-L-23-28-23B-N-2D0-L-N-C

Mobile Sitting Base Cabinet (30")
with phenolic work surface
-2 doors,1 shelf

22.5"(d) x 28"(h) x 22.5"(w)

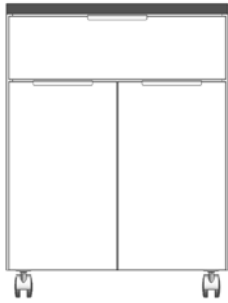

U1-B-C-L-23-28-23B-1DR-2D0-L-N-C

Mobile Sitting Base Cabinet (30")
with phenolic work surface
-1 soft close drawer, 2 doors, 1
shelf

22.5"(d) x 28"(h) x 22.5"(w)

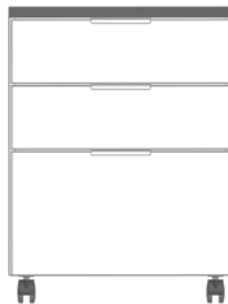

U1-B-H-L-23-28-23N-3DR-N-L-N-C

Mobile Sitting Base Cabinet (30")
with phenolic work surface
-3 soft close drawers

22.5"(d) x 28"(h) x 22.5"(w)

Product Number	Description	D x H x W
----------------	-------------	-----------

WALL SHELF CUBICLES

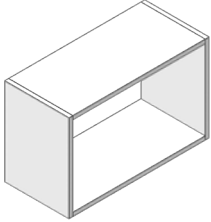

U1-C-B-L-12-15-24N-N-N-L-N-N

Classic Wall Shelf Cubicle,
add-on unit

12"(d) x 15"(h) x 24"(w)

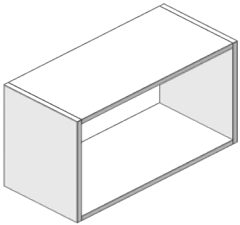

U1-C-B-L-12-15-36N-N-N-L-N-N

Classic Wall Shelf Cubicle,
add-on unit

12"(d) x 15"(h) x 36"(w)

Product Number	Description	D x H x W
----------------	-------------	-----------

SHELF CUBICLE ASSEMBLY

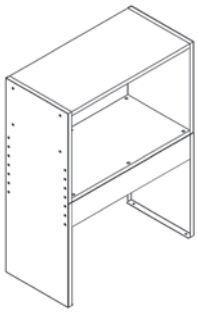

U1-C-BRKT-24-N

Bench Shelf Cubicle Assembly, height adjustable, no power

12"(d) x ADJ (h) x 24"(w)

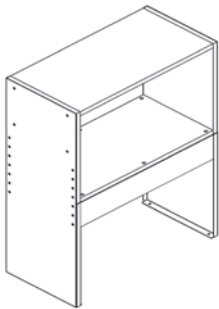

U1-C-BRKT-36-N

Bench Shelf Cubicle Assembly, height adjustable, no power

12"(d) x ADJ (h) x 36"(w)

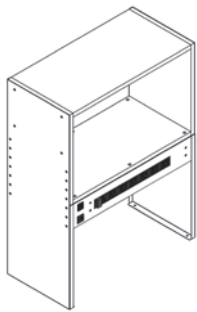

U1-C-BRKT-24-P

Bench Shelf Cubicle Assembly with power bar, height adjustable, provisioned for power and data

12"(d) x ADJ (h) x 24"(w)

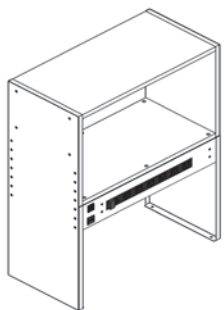

U1-C-BRKT-36-P

Bench Shelf Cubicle Assembly with power bar, height adjustable, provisioned for power and data

12"(d) x ADJ (h) x 36"(w)

Product Number	Description	D x H x W
----------------	-------------	-----------

UPPER CABINETS

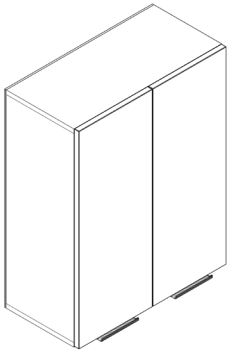

U1-U-B-L-12-30-24B-N-2D0-L-N-N

Upper Cabinet 24" wide
- 2 shelves 2 doors, mounts on wall

12"(d) x 30 3/4"(h) x 24"(w)

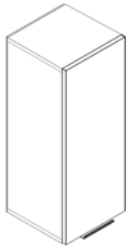

U1-U-B-L-12-30-12(L/R)-N-1D0-L-N-N

Upper Cabinet 12" wide
- 2 shelves 1 door, mounts on wall
-left or right-hand swing

12"(d) x 30 3/4"(h) x 12"(w)

Product Number	Description	D x H x W
----------------	-------------	-----------

UPPER CABINET ASSEMBLY

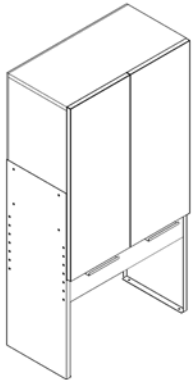

U1-U-BRKT-24-N

Bench Upper Cabinet Assembly, 2 door, height adjustable, no power

12"(d) x ADJ (h) x 24"(w)

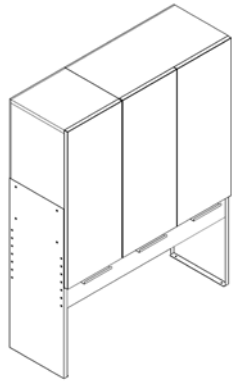

U1-U-BRKT-36-N

Bench Upper Cabinet Assembly, 3 door, height adjustable, no power

12"(d) x ADJ (h) x 36"(w)

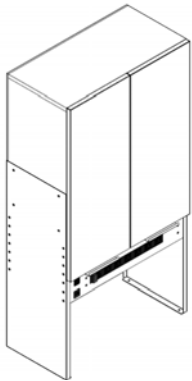

U1-U-BRKT-24-P

Bench Upper Cabinet Assembly with power bar, 2 door height adjustable, provisioned for power and data

12"(d) x ADJ (h) x 24"(w)

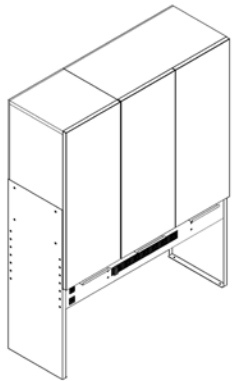

U1-U-BRKT-36-P

Bench Upper Cabinet Assembly with power bar, 3 door height adjustable, provisioned for power and data

12"(d) x ADJ (h) x 36"(w)

Product Number	Description	D x H x W
----------------	-------------	-----------

SITTING HEIGHT BENCHES



U1-TBL-243048-T
U1-TBL-303048-T

48" Wide Sitting Height Bench
-phenolic tops, 1.25" Stainless
steel tube legs, with adjustable
levellers

24"(d) x 30"(h) x 48"(w)
30"(d) x 30"(h) x 48"(w)

U1-TBL-BKSP-48
48" Long Phenolic Backsplash
available, 4" height



U1-TBL-243060-T
U1-TBL-303060-T

60" Wide Sitting Height Bench
-phenolic tops, 1.25" Stainless
steel tube legs, with adjustable
levellers

24"(d) x 30"(h) x 60"(w)
30"(d) x 30"(h) x 60"(w)

U1-TBL-BKSP-60
60" Long Phenolic Backsplash
available, 4" height

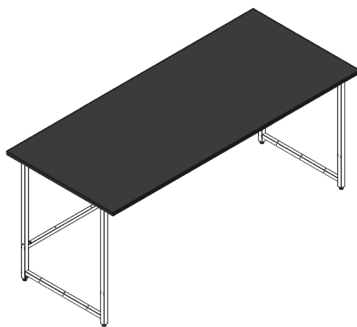

U1-TBL-243072-T
U1-TBL-303072-T
U1-TBL-363072-T

72" Wide Sitting Height Bench
-phenolic tops, 1.25" Stainless
steel tube legs, with adjustable
levellers

24"(d) x 30"(h) x 72"(w)
30"(d) x 30"(h) x 72"(w)
36"(d) x 30"(h) x 72"(w)

U1-TBL-BKSP-72
72" Long Phenolic Backsplash
available, 4" height

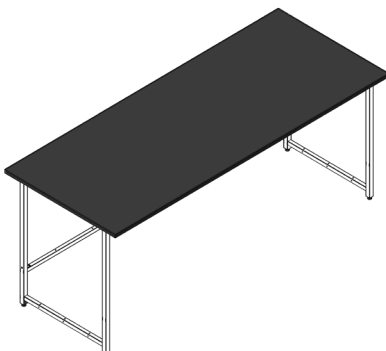

U1-TBL-243096-T
U1-TBL-303096-T
U1-TBL-363096-T

96" Wide Sitting Height Bench
-phenolic tops, 1.25" Stainless
steel tube legs, with adjustable
levellers

24"(d) x 30"(h) x 96"(w)
30"(d) x 30"(h) x 96"(w)
36"(d) x 30"(h) x 96"(w)

U1-TBL-BKSP-96
96" Long Phenolic Backsplash
available, 4" height

Product Number	Description	D x H x W
----------------	-------------	-----------

STANDING HEIGHT BENCHES



U1-TBL-243648-T
U1-TBL-303648-T

48" Wide Standing Height Bench
-phenolic tops, 1.25" Stainless
steel tube legs, with adjustable
levellers

24"(d) x 36"(h) x 48"(w)
30"(d) x 36"(h) x 48"(w)

U1-TBL-BKSP-48
48" Long Phenolic Backsplash
available, 4" height



U1-TBL-243660-T
U1-TBL-303660-T

60" Wide Standing Height Bench
-phenolic tops, 1.25" Stainless
steel tube legs, with adjustable
levellers

24"(d) x 36"(h) x 60"(w)
30"(d) x 36"(h) x 60"(w)

U1-TBL-BKSP-60
60" Long Phenolic Backsplash
available, 4" height

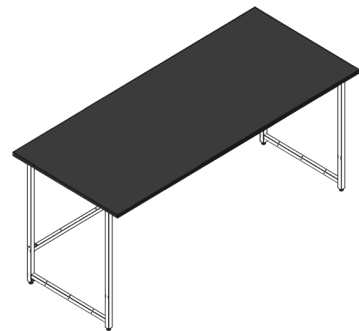

U1-TBL-243672-T
U1-TBL-303672-T
U1-TBL-363672-T

72" Wide Standing Height Bench
-phenolic tops, 1.25" Stainless
steel tube legs, with adjustable
levellers

24"(d) x 36"(h) x 72"(w)
30"(d) x 36"(h) x 72"(w)
36"(d) x 36"(h) x 72"(w)

U1-TBL-BKSP-72
72" Long Phenolic Backsplash
available, 4" height

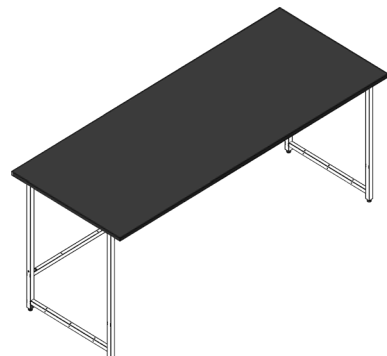

U1-TBL-243696-T
U1-TBL-303696-T
U1-TBL-363696-T

96" Wide Standing Height Bench
-phenolic tops, 1.25" Stainless
steel tube legs, with adjustable
levellers

24"(d) x 36"(h) x 96"(w)
30"(d) x 36"(h) x 96"(w)
36"(d) x 36"(h) x 96"(w)

U1-TBL-BKSP-96
96" Long Phenolic Backsplash
available, 4" height

PLANNING TOOLS

Torvan Medical is always evolving to make lab planning and workflow analysis easier for our customers.

Please visit our website for our updated line of planning tools and models such as online configurators.

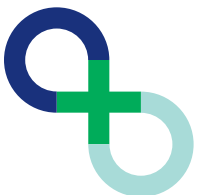

Torvan UNILAB
A division of
Torvan Medical INC

1-888-832-0355

www.torvanmedical.com

