



# PRODUCT BROCHURE

Storage & Workspace Solutions



**THE SCIENCE OF INNOVATION  
THE ART OF DISCOVERY**

# *science of innovation, the art of discovery*

Torvan UNILAB specializes in the development and distribution of forward-thinking products where infection control and cross-contamination is a concern. Our products are built with a high level of attention to craftsmanship and design, which translates to safer, aesthetically pleasing work environments for end-users.



## CONSULTATION

Our experts will ensure you are getting the right furniture for your needs



## MODULAR

Flexible lab furniture that can be assembled according to your lab layout and changing requirements



## QUICK SET-UP

Ship assembled, self install or have our professional team install for you



## SUSTAINABLE

High quality, sustainable materials that are compliant with safety codes and regulations



## MOBILE

Lockable casters on mobile cabinets- easy to move and lock in place for stability  
\*Plus & Stainless available in built-in

# TABLE OF CONTENTS

Unilab Classic.....	03
Classic Base Cabinets.....	04
Classic Benches.....	05
Classic Upper Cabinets.....	07
Classic Shelf Cubicles.....	07
Classic Bench Storage Assembly .....	08
Unilab Plus.....	09
Plus Storage Cabinets.....	10
Plus Base Cabinets.....	11
Plus Wall Cabinets.....	12
Plus Tall Storage.....	12
Plus Benches.....	13
Unilab Stainless.....	15
Stainless Equipment.....	16
Planning Tools.....	17

# ECONOMICAL MODULAR LABORATORY SOLUTIONS

Unilab CLASSIC creates flexible and adaptable laboratory furniture that will help drive efficiency and productivity in scientific workplaces.

- Optimize work-flow for maximum productivity
- Improve organization and accessibility, while saving space
- Support worker well-being through smart ergonomic design
- Easily adapt to changing requirements and conditions
- Stand up to the most demanding environments
- Unique design allows for quick and easy reconfiguration and relocation



# CLASSIC BASE CABINETS

Our mobile base cabinets comprise of phenolic tops which are chemical and scratch resistant, easy to clean, toe kick for sink units, and 4 locking swivel casters for mobile base cabinets.

Shelves where applicable, soft closing slides and european hinges. Both desk and counter height available.

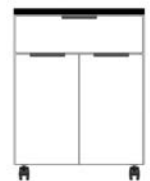
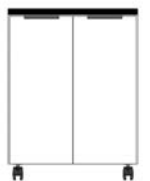
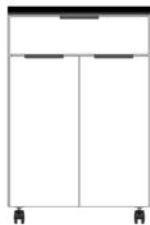
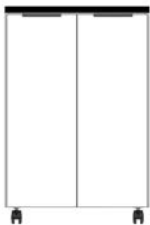

# CLASSIC BENCHES

This modular, budget friendly table makes it perfect for new start up labs, small lab projects, and quick renovations. The classic design allow these tables to seamlessly integrate with any existing lab furniture and current layout.



Classic Benches come with standard phenolic work surfaces, and various heights and sizes, making it ideal for a variety of uses and operations.



Chemical  
Resistant

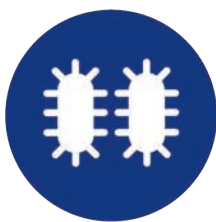

Inhibit Bacterial  
Growth



Scratch & Wear  
Resistant



Easy to Clean



Impact  
Resistant



Easy  
Installation

Phenolic tops are developed using high pressure compact laminate (HPL) and are compliant with the strict laboratory codes and standards. They are well suited for environments where hygiene, contamination control, sustainability, and ergonomics are important.

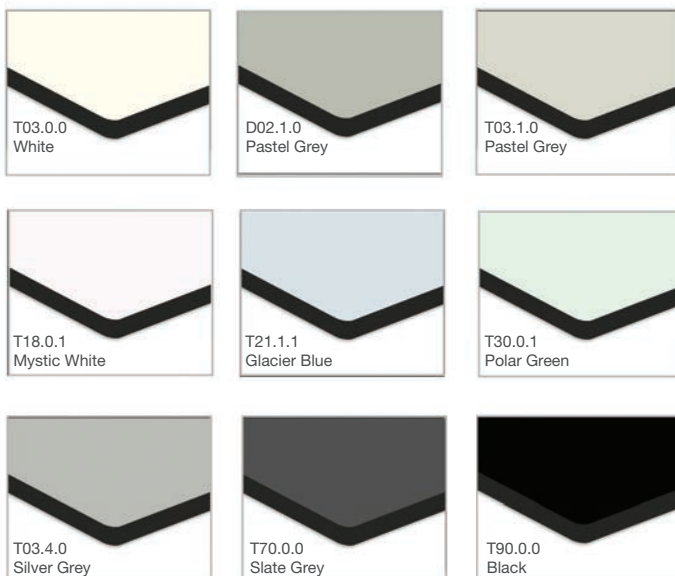

- Ideal for educational, chemical, physical, and analytical laboratories.
- 24 hour chemical resistance based on SEFA 3 test method.
- Easy to clean and highly resistant to most harsh cleaning agents and disinfectants.
- Bacterial growth is not supported.

# CLASSIC UPPER CABINETS



Our affordable, easy to install upper cabinets come with adjustable shelves and european hinges- for soft closing doors.

Upper cabinets can be configured to any table length using our 1 or 2 door units. Attach to your wall or mount them securely on our laboratory tables with our stainless steel assembly units.

# SHELF CUBICLES

Shelf cubicle add ons that can be mounted or securely attached using our height adjustable stainless steel assembly units.

Choose the perfect number of storage units with single shelf cubicle add ons.

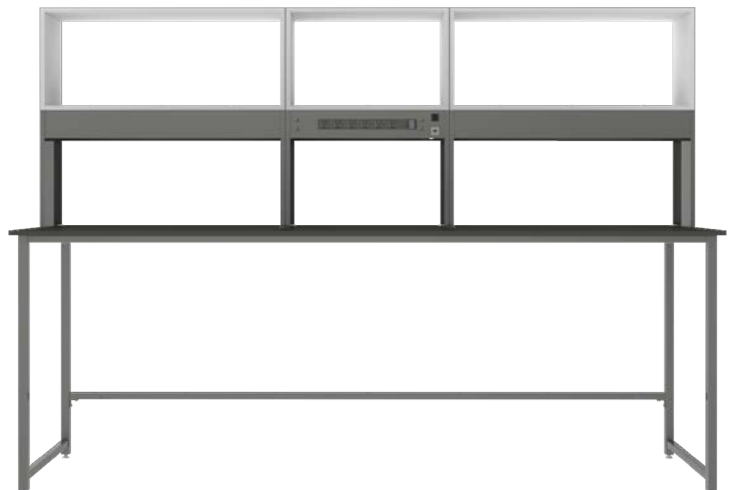



# BENCH STORAGE ASSEMBLIES

Maximize every inch with Torvan UNILAB lab tables and height adjustable assembly units. Height adjustable storage gives laboratories the ability to maximize their unused vertical space.

Made from durable stainless steel to stand up to the harshest applications and environments. Easily assembles in minutes without the use of special tools.

Power bar, data ports, and USB installed on unit as an optional addition. This can be used to conveniently plug in equipment, additional lighting, and laptops.



# MODERN LABORATORY SOLUTIONS

Tailored to meet your specific requirements.

For small to large lab projects that require a more sophisticated and complex level of lab furniture solutions. Providing modular and mobile cabinet and built-in options.



# DURABLE POWDER COATED BUILT TO LAST STORAGE CABINETS

Our full line of wall mount, base, and stand-alone cabinets are the perfect solution for your laboratory storage challenges. Whatever your specifications, our cabinets are designed to be flexible, and fit into any space.

Use the Torvan UNILAB cabinet configurator to find the ideal configuration from cabinet style, material, dimensions, and other modifiers; customize to match your needs.



# BASE CABINETS

Maximize storage with modern laboratory cabinetry. The PLUS cabinetry line has a wide selection of base cabinets, available in mobile or built in.

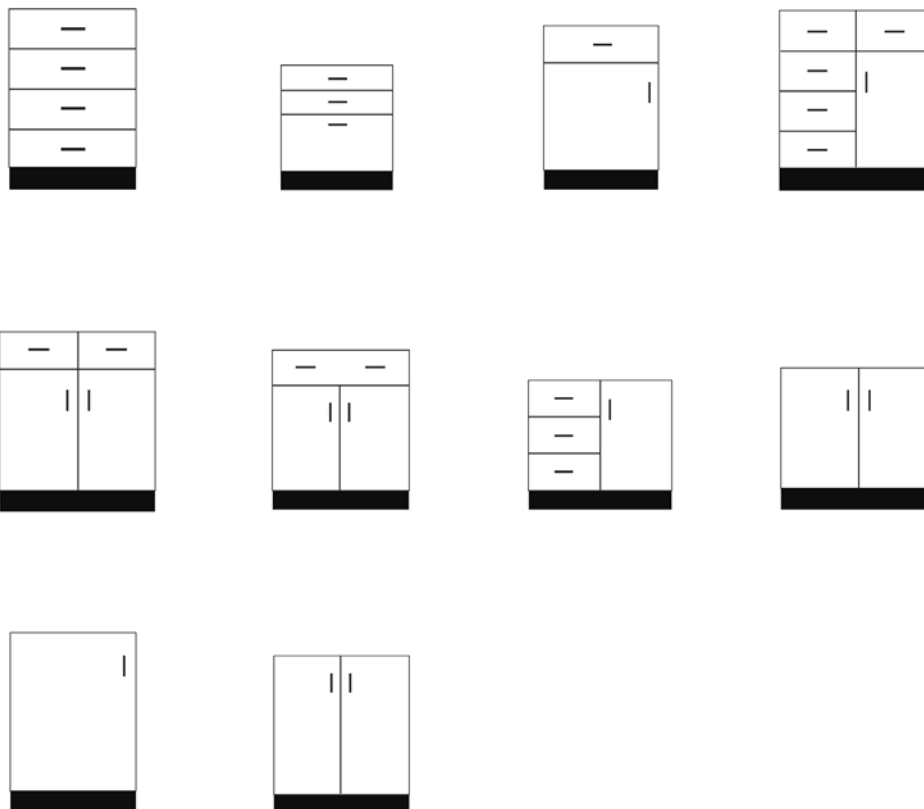

# WALL CABINETS



Design the Wall Cabinet that works for your lab using the cabinet configurator, select from cabinet front style, material, height, and width to efficiently organize, store, and access lab materials or equipment.

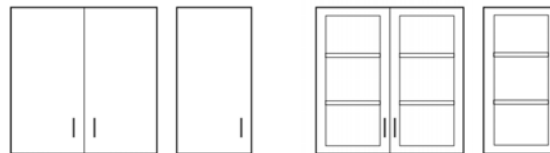

# TALL STORAGE

Maximize your vertical storage space with our Tall Storage Cabinet options.

Both versatile and durable, these will fit your storage requirements across a range of layouts.



# ERGONOMIC MULTI-USER POWDER COATED BENCHES

Height adjustable benches are ideally suited for environments where multiple users utilize the same work space. Designed with the operator in mind, they easily adjust in height to align to individual user comfort and changing tasks.

Modular unit that are easily configurable, can be built back to back, side to side, or form complete island formations.



# HEIGHT ADJUSTABLE BENCH

## Features include:

Height Adjustability: made easy without the use of tools

Complete Assemblies: allowing them to be stand-alone benches or built-in

Quick Release Fasteners: benches can be disconnected from the core for easy relocation and repurposing

Tapered Profiles: allows sight lines to be maintained

Concealed Services: an efficient design that allows equipment to be positioned more easily - providing a clean, uncluttered work space

Available Custom End Panels: variety of different patterns and materials for a custom, modern look

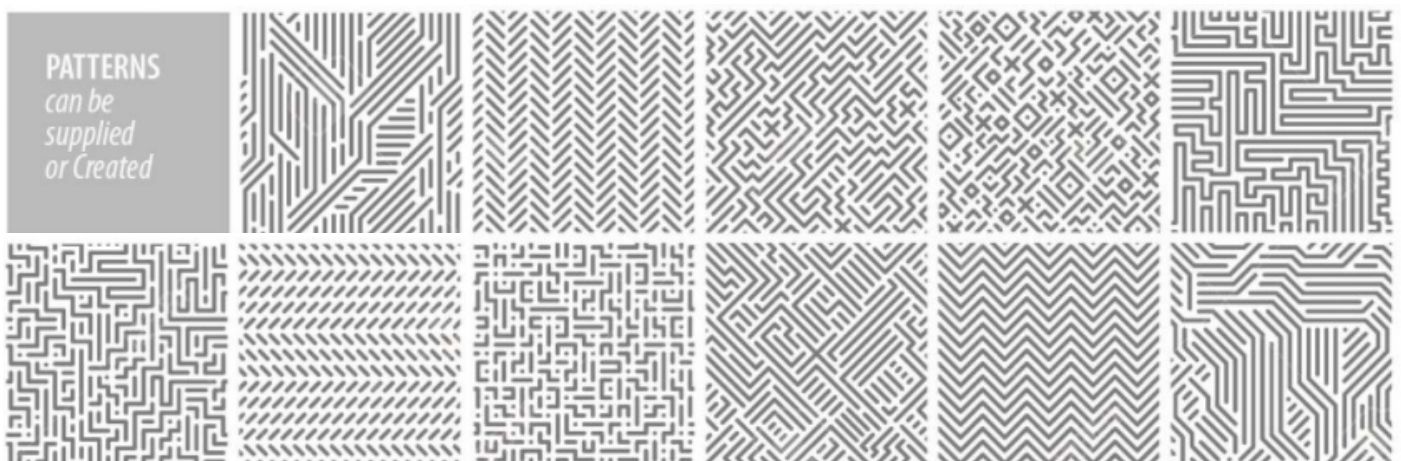

# SPECIALIZED TIER 1 ENVIRONMENTS STAINLESS

All Unilab PLUS casework also available in stainless steel. Ideal for workplaces that require high levels of sanitation, and resistance to chemical and heat damage.

Our comprehensive STAINLESS line includes cabinetry, lab benches, storage units, both upper and standing, pathology grossing stations, dissection tables, sterile storage cabinets.

Normally built using 304 Stainless steel (other alloys such as 316 available) our stainless equipment meets all requirements for medical, industrial, and scientific needs.







### HEIGHT ADJUSTABLE SINK

Multi-basin sinks and counters are reliable and easy to clean, and can be easily customized to fit your environment.

Touchscreen control, gesture sensors, electronic drains, and height adjustment available; this sink is built to maximize comfort and minimize cross contamination.



### HEIGHT ADJUSTABLE WORKSTATION

Programmable height adjustment, adjustable overhead task light, column mounted electrical power strip enables productivity.

Vertical pegboards to mount accessories, helps users maintain a clutter free workspace. Also available with phenolic worksurfaces.



### CLEAN ROOM/ PHARMACEUTICAL

Cleanrooms and pharmaceutical labs can be fully outfitted using our case work and passthroughs.

Used in conjunction with our free planning tools, workspaces can be optimized for best workflow and budget.



### PATHOLOGY

Our pathology line of products includes autopsy tables, dissection stations, grossing stations, cadaver lifts and other specialized equipment.

Available in custom or standard configurations, the designs are built to make clean efficient work spaces.

# PLANNING TOOLS

Torvan Medical is always evolving to make lab planning and workflow analysis easier for our customers.

Please visit our website for our updated line of planning tools and models such as online configurators.



Torvan UNILAB  
A division of  
**Torvan Medical INC**

1-888-832-0355

[www.torvanmedical.com](http://www.torvanmedical.com)



FM 692762